

EVA0411-F04 Technical Data

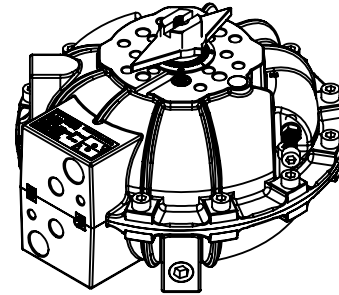

MOUNTING DIMENSIONS PER
ISO 5211-2001(E)
DIN 3337(OPTIONAL)
NAMUR VDI/VE 3845

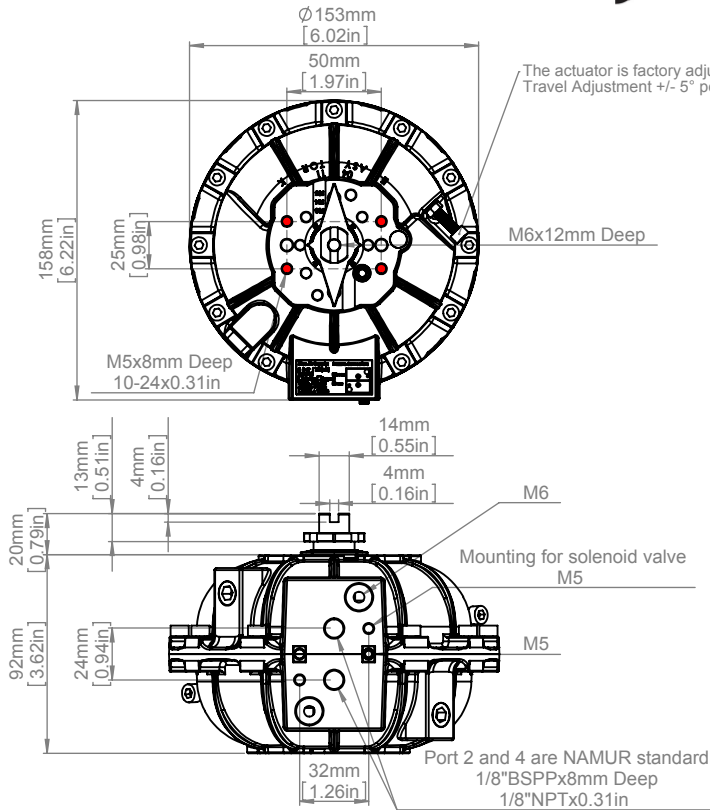

Semi Direct Mount-(With Optional Shaft)

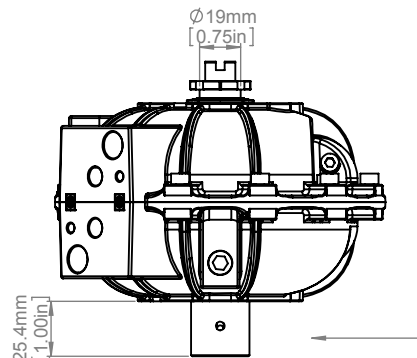

Model 0411 ISO F03/F05 Pattern 45° Shift

Model 0411 ISO F04 Pattern 0° Shift

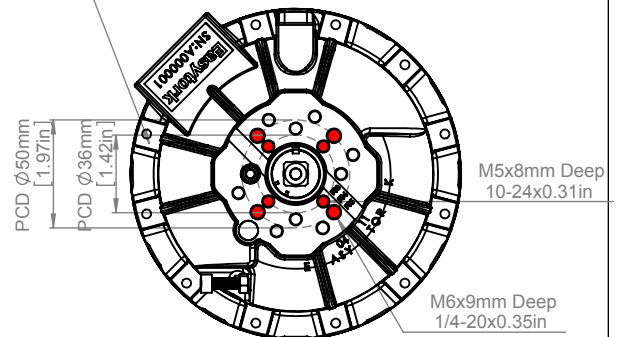
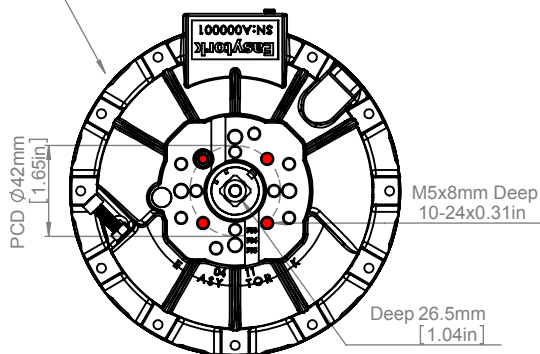

(1) & (2) Users can change the lower shaft

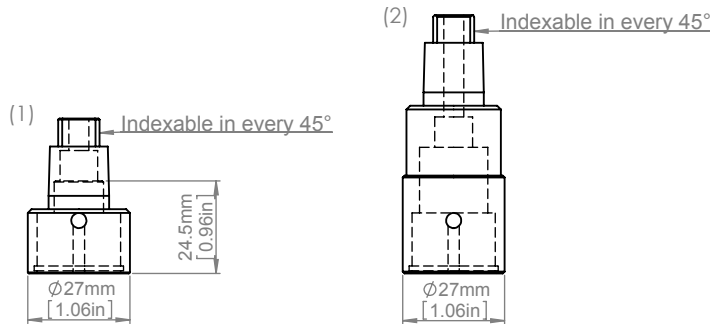

Standard Insert



All actuators are fitted with adaptable drive inserts in order to accommodate different valve stem profiles. custom DD, Bore & key, Sq shape available

Note:

- Output torque:
384 In/Lb 43.3 Nm at 80 psi / 5.5 bar - Double Acting
250 In/Lb 28.2 Nm at 80 psi / 5.5bar - Fail Safe
- Pressure rating 2-10 bar (30-150 psi)
- Actuator shown in full CW position
- Travel adjustment ±5° per stopper bolt
- Ancillaries attachment size AA0
- Weight 1.7 kgs (3.7 lbs)
- Air consumption per stroke at 5.5 bar (80psi)
0.98L (60 cu-in)
- Standard Coating finish material: epoxy
- Temp range: Silicone vane seal -40°C to -120°C or
-40°F to 248°F

Easytork Automation Corporation

2505 Metro Blvd, Suite A/B, Maryland Heights, 63043 USA
info@easytork.com www.easytork.com